



Valves for water

RUBINETTERIA IDRAULICA



BIANCHI F.LLi
Rubineria

CARATTERISTICHE TECNICO/COSTRUTTIVE GENERALI

- **Materiali**

- Corpo e accessori: ottone UNI EN 12165-CW617N stampato a caldo e ottone UNI EN 12164-CW614N tornito
- Guarnizioni: NBR e PTFE puro
- Tipi di filettature: ISO 228
- Durante le lavorazioni tutti i particolari sono controllati secondo modalità definite nelle procedure del sistema qualità aziendale, certificato secondo la norma ISO 9001/2000

Le caratteristiche e le misure sono indicative e non impegnano la BIANCHI F.LLI, che si riserva il diritto di apportare ai propri articoli, in qualunque momento e senza preavviso, modifiche tecniche o commerciali.

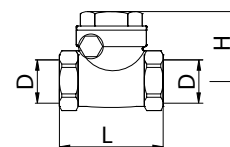

Valvola clapet
Swing check brass valve
Válvula clapet

439

Code	Version	Size (D)	Smooth	€	D1	H	L	M	Pack
4390000300		3/8	●	6,02	-	50	43	-	16
4390000400		1/2	●	5,88	-	50	44	-	16
4390000500		3/4	●	7,94	-	58	53	-	12
4390000600		1"	●	11,71	-	67	63	-	8
4390000700		1" 1/4	●	17,26	-	77	72	-	5
4390000800		1" 1/2	●	22,15	-	88	82	-	4
4390000900		2"	●	31,44	-	101	95	-	2
4390001000		2" 1/2	●	63,11	-	130	119	-	1
4390001100		3"	●	87,63	-	150	133	-	1
4390001200		4"	●	160,28	-	185	168	-	1



Valvola di fondo
Brass foot valve
Válvula de fondo

441

Code	Version	Size (D)	Smooth	€	D1	H	L	M	Pack
4410000400		1/2	●	6,16	-	60	39	-	20
4410000500		3/4	●	6,74	-	69	45	-	12
4410000600		1"	●	8,09	-	80	51	-	12
4410000700		1" 1/4	●	11,96	-	92	61	-	5
4410000800		1" 1/2	●	15,61	-	100	68	-	3
4410000900		2"	●	22,11	-	117	80	-	2
4410001000		2" 1/2	●	39,65	-	140	100	-	1
4410001100		3"	●	53,69	-	173	121	-	1
4410001200		4"	●	93,03	-	194	145	-	1

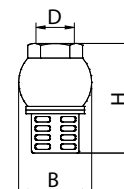

Valvola di ritegno
Brass check valve
Válvula de retención

442

Code	Version	Size (D)	Smooth	€	D1	H	L	M	Pack
4420000300		3/8	●	5,79	-	54	34	-	10
4420000400		1/2	●	5,84	-	57	34	-	10
4420000500		3/4	●	7,99	-	64	42	-	8
4420000600		1"	●	10,94	-	75	48	-	6
4420000700		1" 1/4	●	17,16	-	82	60	-	4
4420000800		1" 1/2	●	23,39	-	93	71	-	4
4420000900		2"	●	36,18	-	100	87	-	2
4420001000		2" 1/2	●	84,12	-	120	120	-	1
4420001100		3"	●	126,77	-	140	140	-	1
4420001200		4"	●	208,11	-	158	173	-	1

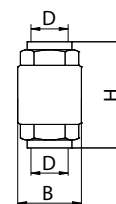

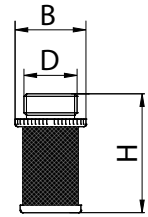

Filtro per valvola di ritegno
Filter for brass check valve
Filtro para válvula de retención

444

Code	Version	Size (D)	Smooth	€	D1	H	L	M	Pack
4440000300		3/8	●	1,24	-	43	22	-	30
4440000400		1/2	●	1,26	-	46	28	-	50
4440000500		3/4	●	1,43	-	57	33	-	20
4440000600		1"	●	1,58	-	69	42	-	20
4440000700		1" 1/4	●	2,09	-	75	50	-	12
4440000800		1" 1/2	●	2,53	-	84	55	-	12
4440000900		2"	●	3,42	-	99	67	-	6
4440001000		2" 1/2	●	6,97	-	123	86	-	1
4440001100		3"	●	8,60	-	138	102	-	1
4440001200		4"	●	11,65	-	153	129	-	1

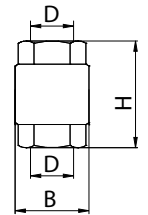

Valvola di ritegno tipo york
Brass check valve, york type
Válvula de retención tipo york

442Y

Code	Version	Size (D)	Smooth	€	D1	H	L	M	Pack
442Y000400		1/2	●	4,28	-	47	34	-	10
442Y000500		3/4	●	5,89	-	53	42	-	8
442Y000600		1"	●	7,55	-	60	47	-	8
442Y000700		1" 1/4	●	10,94	-	66	59	-	6
442Y000800		1" 1/2	●	16,68	-	74	71	-	4
442Y000900		2"	●	22,84	-	80	86	-	2
442Y001000		2" 1/2	●	43,21	-	98	102	-	1
442Y001100		3"	●	60,94	-	103	125	-	1
442Y001200		4"	●	106,05	-	118	154	-	1

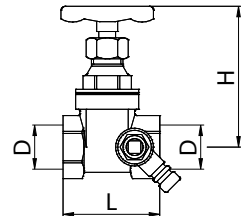

Saracinesca in ottone pesante
con spurgo
Heavy pattern brass gate valve
with drain
Cierre de latón pesado con
purga

443

Code	Version	Size (D)	Smooth	€	D1	H	L	M	Pack
4430000400		1/2	●	10,89	-	73	44	-	20
4430000500		3/4	●	13,44	-	78	49	-	10
4430000600		1"	●	16,88	-	92	52	-	10
4430000700		1" 1/4	●	21,57	-	106	58	-	10
4430000800		1" 1/2	●	26,42	-	122	62	-	5
4430000900		2"	●	36,86	-	143	66	-	1



Saracinesca in ottone pesante
Heavy pattern brass gate valve
Cierre de latón pesado

445

Code	Version	Size (D)	Smooth	€	D1	H	L	M	Pack
4450000300		3/8	●	5,32	-	67	33	-	20
4450000400		1/2	●	6,20	-	68	43	-	20
4450000500		3/4	●	8,51	-	78	47	-	20
4450000600		1"	●	11,96	-	93	53	-	10
4450000700		1" 1/4	●	17,13	-	108	57	-	10
4450000800		1" 1/2	●	22,55	-	125	61	-	5
4450000900		2"	●	33,14	-	143	67	-	5
4450001000		2" 1/2	●	51,56	-	175	74	-	1
4450001100		3"	●	69,80	-	200	86	-	1
4450001200		4"	●	123,96	-	235	98	-	1

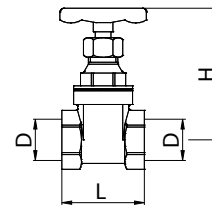

Saracinesca in ottone leggero
Light pattern brass gate valve
Cierre de latón ligero

446

Code	Version	Size (D)	Smooth	€	D1	H	L	M	Pack
4460000300		3/8	●	5,32	-	67	33	-	20
4460000400		1/2	●	4,91	-	68	35	-	20
4460000500		3/4	●	5,43	-	68	39	-	20
4460000600		1"	●	7,81	-	80	43	-	20
4460000700		1" 1/4	●	12,02	-	86	48	-	10
4460000800		1" 1/2	●	15,40	-	107	54	-	5
4460000900		2"	●	23,48	-	134	58	-	5
4460001000		2" 1/2	●	44,10	-	-	-	-	1
4460001100		3"	●	55,96	-	-	-	-	1
4460001200		4"	●	105,28	-	-	-	-	1

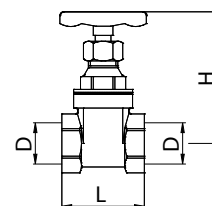

Rubinetto arresto pesante
Heavy pattern stop cock
Llave de cierre pesada

450

Code	Version	Size (D)	Smooth	€	D1	H	L	M	Pack
4500000400		1/2	●	7,95	-	68	66	-	1
4500000500		3/4	●	11,21	-	76	74	-	1
4500000600		1"	●	17,46	-	98	99	-	1
4500000700		1" 1/4	●	28,05	-	104	93	-	1
4500000800		1" 1/2	●	36,57	-	110	102	-	1
4500000900		2"	●	56,90	-	130	118	-	1

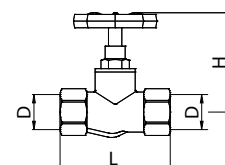



Valvola di sicurezza per scaldabagno
Safety valve for boiler
Válvula de seguridad calentador

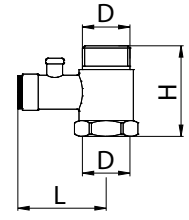

453

Code	Version	Size (D)	Smooth	€	D1	H	L	M	Pack
4530000400		1/2	●	4,13	-	40	39	-	20



Rubinetto incasso con cappuccio
Heavy pattern built-in valve with chromed cap
LLave para encastrar con capuchón

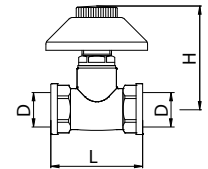

454

Code	Version	Size (D)	Smooth	€	D1	H	L	M	Pack
4540000400		1/2	●	10,30	-	85	54	-	8
4540000500		3/4	●	11,63	-	85	60	-	6

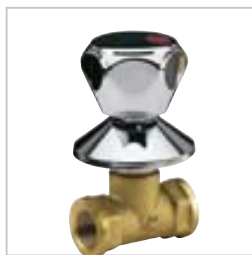

Rubinetto incasso con maniglia
Heavy pattern built-in valve with chromed handle
LLave para encastrar con manija

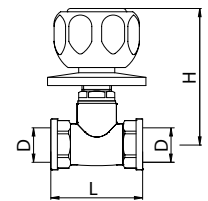

455

Code	Version	Size (D)	Smooth	€	D1	H	L	M	Pack
4550000400		1/2	●	11,44	-	90	54	-	8
4550000500		3/4	●	13,05	-	90	59	-	6



Valvola inclinata
Oblique valve
Válvula inclinada

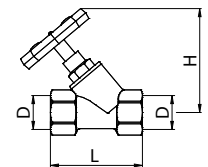

457

Code	Version	Size (D)	Smooth	€	D1	H	L	M	Pack
4570000400		1/2	●	7,06	-	65	57	-	-
4570000500		3/4	●	10,42	-	74	66	-	-
4570000600		1"	●	15,87	-	95	80	-	-
4570000700		1" 1/4	●	26,45	-	110	92	-	-
4570000800		1" 1/2	●	32,14	-	122	101	-	-
4570000900		2"	●	50,54	-	135	123	-	-



Filtro inclinato per acqua e gas
Strainer valve with filter for water and gas
Filtro inclinado para agua y gas

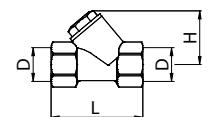

459

Code	Version	Size (D)	Smooth	€	D1	H	L	M	Pack
4590000400		1/2	●	4,62	-	40	58	-	20
4590000500		3/4	●	6,61	-	50	70	-	10
4590000600		1"	●	12,14	-	60	87	-	6
4590000700		1" 1/4	●	16,10	-	68	96	-	5
4590000800		1" 1/2	●	20,40	-	75	106	-	4
4590000900		2"	●	34,84	-	90	126	-	2



Rubinetto gas FF con quadro
Square head female-female gas cock
Llave gas HH con cabeza cuadrada

470

Code	Version	Size (D)	Smooth	€	D1	H	L	M	Pack
4700000300		3/8	●	6,10	-	56	46	-	12
4700000400		1/2	●	6,10	-	56	48	-	12
4700000500		3/4	●	7,15	-	69	56	-	12
4700000600		1"	●	9,57	-	69	68	-	6
4700000700		1" 1/4	●	15,07	-	91	78	-	5

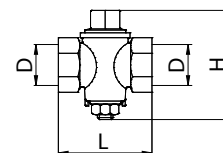

Rubinetto gas MF con quadro
Square head male-female gas cock
Llave gas MH con cabeza cuadrada

476

Code	Version	Size (D)	Smooth	€	D1	H	L	M	Pack
4760000700		1" 1/4	●	17,25	-	91	82	-	1

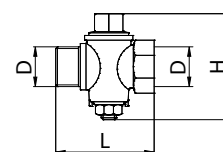

Rubinetto scarico caldaia con tappo e portagomma
Drain cock for boiler with cap and hose connection
Llave de evacuación caldera con tapón y portagoma

476C

Code	Version	Size (D)	Smooth	€	D1	H	L	M	Pack
476C000300		3/8	●	6,12	-	28	74	-	1
476C000400		1/2	●	6,12	-	31	76	-	1
476C000500		3/4	●	11,21	-	38	91	-	1

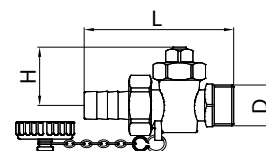

Rubinetto a sfera scarico caldaia con tappo e portagomma
Drain ball valve for boiler with cap and hose connection
Llave de bola evacuación caldera con tapón y portagoma

476CS

Code	Version	Size (D)	Smooth	€	D1	H	L	M	Pack
476S000300		3/8	●	5,25	-	35	65	-	1
476S000400		1/2	●	5,25	-	35	65	-	1

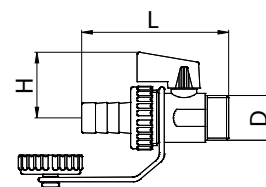



Rubinetto a sfera per serbatoio con portagomma
Oil barrel ball bibcock with hose connection
Llave de bola para depósito con portagoma

479

Code	Version	Size (D)	Smooth	€	D1	H	L	M	Pack
4790000400		1/2	●	7,84	-	-	102	-	8
4790000500		3/4	●	8,48	-	-	102	-	8

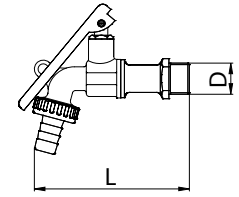

Rubinetto curvo lucido con portagomma
Hose bibcock, polished brass
Llave curva con portagoma brillante

484

Code	Version	Size (D)	Smooth	€	D1	H	L	M	Pack
4840000400		1/2	●	12,10	-	130	118	-	10
4840C00400		1/2	●	13,14	-	130	118	-	10
4840000500		3/4	●	17,28	-	145	122	-	5
4840C00500		3/4	●	18,40	-	145	122	-	5

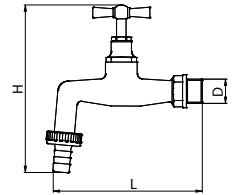

Rubinetto a sfera curvo con portagomma, maniglia a leva, tipo pesante
Heavy pattern ball bibcock with hose connection, lever handle
Llave de bola curva con portagoma, manija de palanca, tipo pesado

485

Code	Version	Size (D)	Smooth	€	D1	H	L	M	Pack
485000030F		3/8	●	7,00	-	-	101	84	6
485000040F		1/2	●	6,81	-	-	102	84	6
485000050F		3/4	●	9,08	-	-	115	84	6
485000060F		1"	●	16,68	-	-	138	88	5

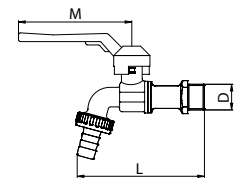

Rubinetto a sfera curvo con portagomma, maniglia a leva
Ball bibcock with hose connection, lever handle
Llave de bola curva con portagoma, manija de palanca

4851

Code	Version	Size (D)	Smooth	€	D1	H	L	M	Pack
485100040A		1/2	●	5,79	-	-	98	86	10
485100050A		3/4	●	8,12	-	-	114	86	-

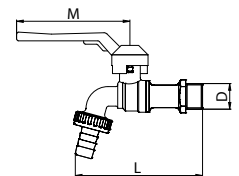



Rubinetto a sfera curvo con portagomma, maniglia a farfalla, tipo pesante

Heavy pattern ball bibcock with hose connection, T-handle

Llave de bola curva con portagoma, manija de mariposa, tipo pesado



Rubinetto a sfera curvo con portagomma, maniglia a farfalla

Ball bibcock with hose connection, T-handle

Llave de bola curva con portagoma, manija de mariposa

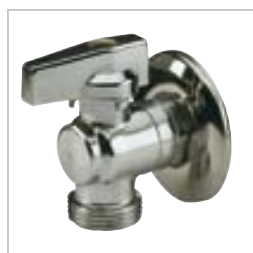

Rubinetto a squadra attacco lavatrice con rosone

Angle ball valve for washing-machine with rosette

Llave de escuadra con empalme lavadora con roseta



Rubinetto a squadra attacco lavatrice con rosone, modello leggero

Angle ball valve for washing-machine with rosette, light pattern

Llave de escuadra empalme lavadora con roseta, modelo ligero

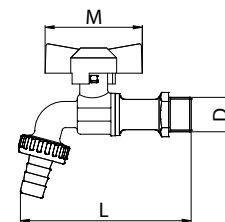

487

Code	Version	Size (D)	Smooth	€	D1	H	L	M	Pack
487000030F		3/8	●	7,00	-	-	101	54	6
487000040F		1/2	●	6,81	-	-	102	54	6
487000050F		3/4	●	9,08	-	-	115	54	6
487000060F		1"	●	16,68	-	-	138	88	5

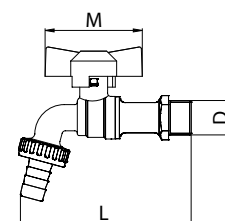

4871

Code	Version	Size (D)	Smooth	€	D1	H	L	M	Pack
487100040F		1/2	●	5,79	-	-	98	54	10
487100050F		3/4	●	8,12	-	-	114	54	10

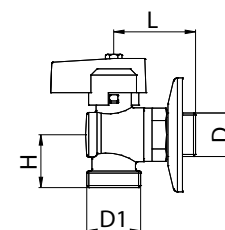

489

Code	Version	Size (D)	Smooth	€	D1	H	L	M	Pack
489000040Q		1/2	●	6,33	3/4	26	42	-	10

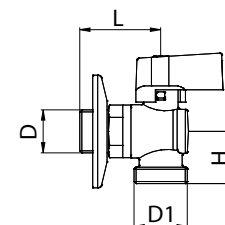

4891

Code	Version	Size (D)	Smooth	€	D1	H	L	M	Pack
489104040Q		1/2 x 1/2	●	5,33	1/2	26	39	-	10
489104050Q		1/2 x 3/4	●	5,33	3/4	26	39	-	10



Rubinetto squadra a sfera attacco MM con leva in zama nichelata

Angle ball valve male connection, nichel zama lever handle

Llave de escuadra de bola empalme MM con zama en manejar niquelado

4892

Code	Version	Size (D)	Smooth	€	D1	H	h	l	L	Pack
489204040Q	-	1/2X1/2	●	5,89	1/2	80	32	-	30,5	-
489204050Q	-	1/2X3/4	●	6,48	3/4	80	32	-	32	-

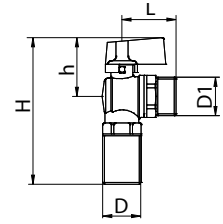

Idrante da giardino

Garden cock

Boca de riego de jardin

498

Code	Version	Size (D)	Smooth	€	D1	H	L	M	Pack
4980000400		1/2	●	11,44	-	82	57	-	12
4980000500		3/4	●	14,47	-	91	60	-	10
4980000600		1"	●	24,36	-	108	73	-	5

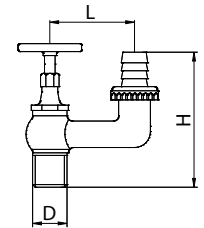

Valvola a sfera per pompa

Isolating pump ball valve

Válvula de bola para pompa

820

Code	Version	Size (D)	Smooth	€	D1	H	L	M	Pack
8200083200		22	●	8,94	1" 1/2	-	58	-	1
8200083800		28	●	10,30	1" 1/2	-	56	-	1

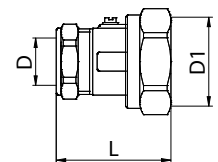

Valvola a sfera F per pompa

Isolating pump F ball valve

Válvula de bola H para pompa

821

Code	Version	Size (D)	Smooth	€	D1	H	L	M	Pack
8210080600		1"	●	8,99	1" 1/2	-	52	-	1

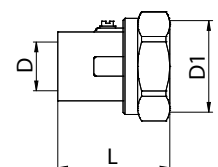

www.bianchifratelli.it

